



## GILDA COURT, WATFORD WAY

HENDON, NW7 2QL

£1,850 PER MONTH

\*\*STUDENT SEPTEMBER 2025 \*\*Spacious three double bedroom flat, ground floor, fitted kitchen, separate kitchen, wooden floors throughout, off street parking, close to public transport links, ideal for sharers or students . Available 16th September 2025.



JAYSON  
RUSSELL

## GROUND FLOOR

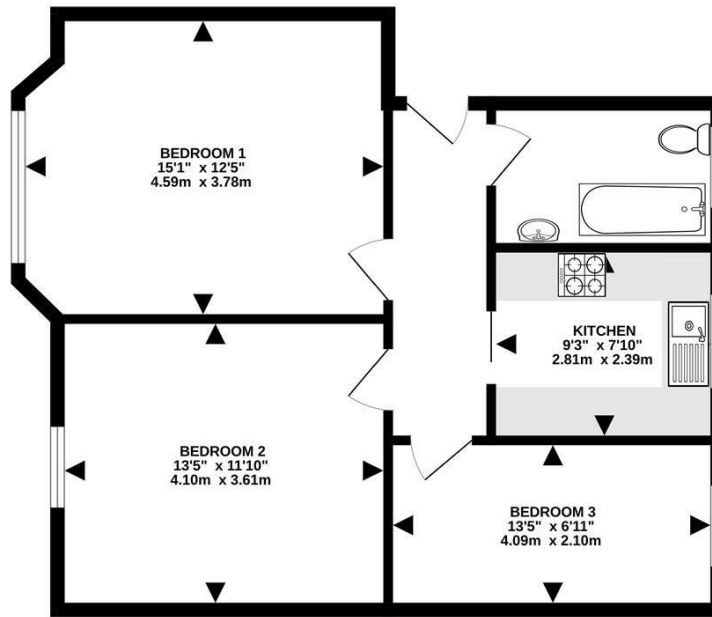

Whilst every attempt has been made to ensure the accuracy of the floorplan contained here, measurements of doors, windows, rooms and any other items are approximate and no responsibility is taken for any error, omission or mis-statement. This plan is for illustrative purposes only and should be used as such by any prospective purchaser. The services, systems and appliances shown have not been tested and no guarantee as to their condition or efficiency can be given.  
Made with Miroplan ©2022



Energy Efficiency Rating		
	Current	Potential
Very energy efficient - lower running costs		
(92 plus) <b>A</b>		
(81-91) <b>B</b>		
(69-80) <b>C</b>		77
(55-68) <b>D</b>	62	
(39-54) <b>E</b>		
(21-38) <b>F</b>		
(1-20) <b>G</b>		
Not energy efficient - higher running costs		
<b>England &amp; Wales</b>	EU Directive 2002/91/EC	

Agents Note: Whilst every care has been taken to prepare these particulars, they are for guidance purposes only. All measurements are approximate and are for general guidance purposes only and whilst every care has been taken to ensure their accuracy, they should not be relied upon and potential buyers/tenants are advised to recheck the measurements

Hendon Lettings  
20 Parson Street  
London  
NW4 1QB

0208 202 1111  
info@jaysonrussell.com  
www.jaysonrussell.com

